

DOUBLE EX D PROXIMITY S.S.316 LIMIT SWITCH

Model SS9jn

The SS9jn Limit Switch Assembly is an accessory which enables remote signaling upon the opening and closing of BERMAD Deluge and Water Control Valves. The proximity sensor within the switch is hermetically sealed and responds by its proximity to a ferromagnetic target attached to the valve's indicator stem. This limit switch assembly is suitable for harsh environments, it is constructed entirely of 316 stainless steel, and is equipped with a rigid proximity magnetic switch sensor. The switch is suitable for hazardous locations. The switch is equipped with Rhodium contacts and is electrically rated for 2.5 Amps at 24VDC.



Technical Data

- All Stainless steel 316
- Magnetic proximity switch sensor
- SPDT (single pole double throw), 1NO, 1NC
- Rhodium contacts
- Electric Entry - M20x1.5
- IP 66/67 & 68 rated
- SIL 2 Safety rating
- Maximum Current @ 24 Vdc - 2.5 Amps
- Operating Temperature - Ex db: -20°C to +70°C / -4°F to +158°F ;
- UL: -40°C to +105°C / -40°F to +221°F
- Hazloc - Zone 1, 2, 21, 22 | Class I & II Div 1 II 2 G Ex d IIC T6

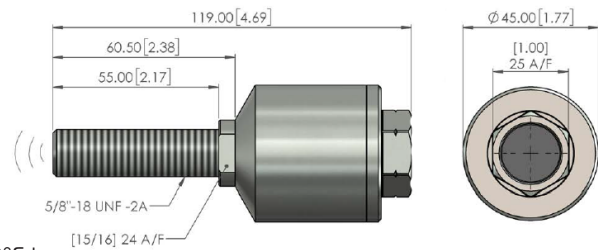

Certification and Approvals

- ATEX/IECEX d/db/tb | UL & CSA | INMETRO

Features

- Rigid construction
- Vibration resistant technology

Materials of Construction

- Valve plug, cover plug, Bracket nut, cam: Stainless steel 316
- Wetted parts: Stainless steel 316
- Sensor: Stainless steel 316L

Optional Materials for Wetted Parts

- Ni.Al.Bronze and Monel
- Hastelloy C276

